

Public Meeting

November 23, 2009
7 p.m.

City Hall – Council Chambers
Jersey City, New Jersey

Chromium Cleanup
Partnership

N.J. DEPARTMENT OF ENVIRONMENTAL PROTECTION
CITY OF JERSEY CITY
PPG INDUSTRIES
COURT-APPOINTED SITE ADMINISTRATOR

Public Meeting Overview

- Settlement Overview
- Activity Report
- 5-Year Master Schedule
- Residential Testing Program
- Community Health
- Local Hiring Program

Settlement Overview

- On June 26, 2009, DEP, Jersey City and PPG signed a settlement in Superior Court where they agreed to work together to cleanup PPG's chromium sites.
- The agreement:
 - Establishes a 5-year goal to clean up all 20 sites;
 - Creates new position of an independent, court-appointed Site Administrator;
 - Creates new position of an independent Technical Consultant;

Settlement Overview

- The agreement also:
 - Establishes residential site testing and cleanup program for chrome waste;
 - Directs the Site Administrator to review existing health studies, consult with experts and recommend further actions, if necessary; and
 - Requires PPG to make reasonable efforts to hire 20% of its cleanup workforce from Jersey City and to establish a training program for City residents.

Settlement Overview

New Positions: Roles and Responsibilities

Independent, court-appointed Site Administrator:

- Develop 5-year Master Schedule and require all parties meet schedule deadlines;
- Hire independent Technical Consultant and experts, as needed;
- Review existing health studies and make recommendations for further actions, if necessary;
- Coordinate residential testing and cleanup program for chrome waste; and
- Communicate with affected community, solicit input, and convey community concerns to the partnership.

Settlement Overview

New Positions: Roles and Responsibilities

Independent Technical Consultant:

- Provide technical review and evaluation of cleanup workplans in support of DEP's regulatory responsibilities;
- Review all workplans to ensure they meet all site cleanup and regulatory requirements; and
- Meet with the community to discuss proposed cleanup plans.

Activity Report

■ 2009

- June 26 Settlement Signed by Judge Oliveri
- July 6 Site Administrator Appointed
- Aug. 3 Work Groups Formed/Near-term Goals Set
- Oct. 26 Technical Consultant Search Completed
- Nov. 23 Master Schedule Public Draft Review
- Dec. 1 20% Jersey City Hiring Program Guidelines

■ 2010

- Jan. 18 Residential Sampling/Cleanup Program
- Jan. 26 Health Study Recommendation

■ Ongoing

- Community Outreach

Master Schedule Overview

- 5-Year Master Schedule - one of the principal tasks assigned to the Site Administrator under the settlement
- Prioritizes 20 sites and stages activity and resources
- Technical working group produced draft
- 10 year cleanup compressed to 5 years –
In detail, there are over 1,100 tasks
- Master Schedule is not a Master Plan
- Community review and input will occur throughout the process

Cleanup Locations

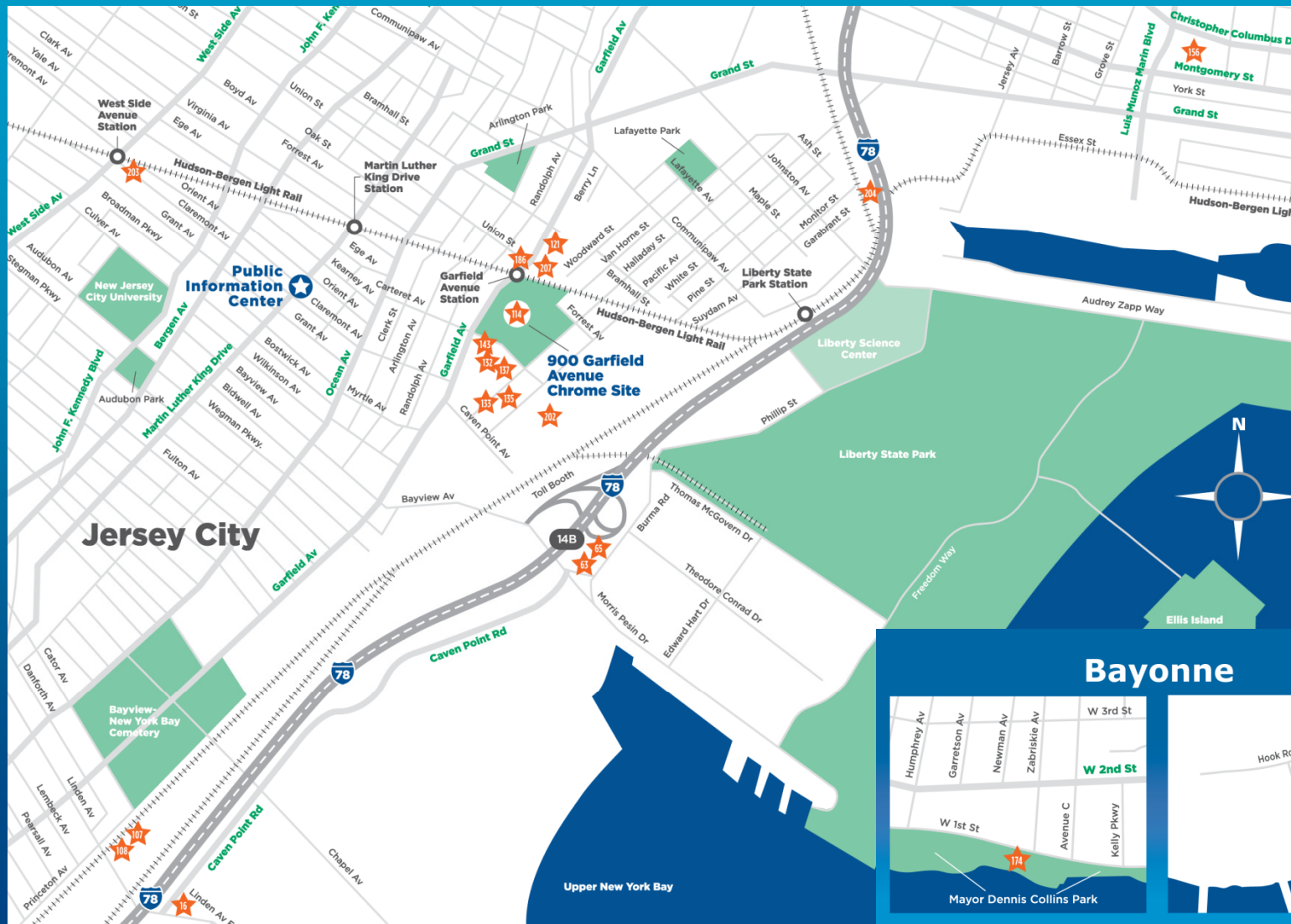

900 Garfield and Berry Lane

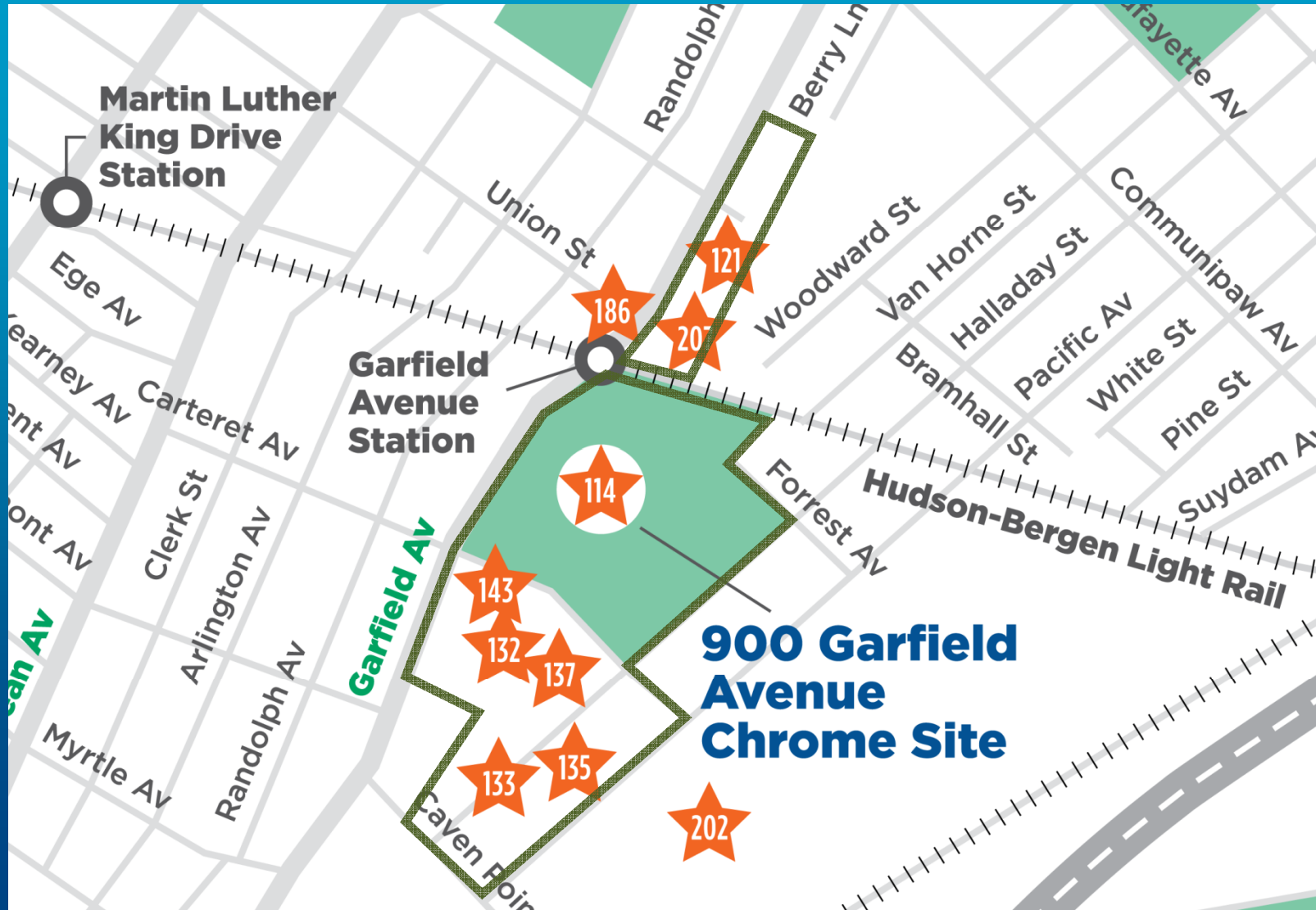

Canal Crossing

Redevelopment Plan

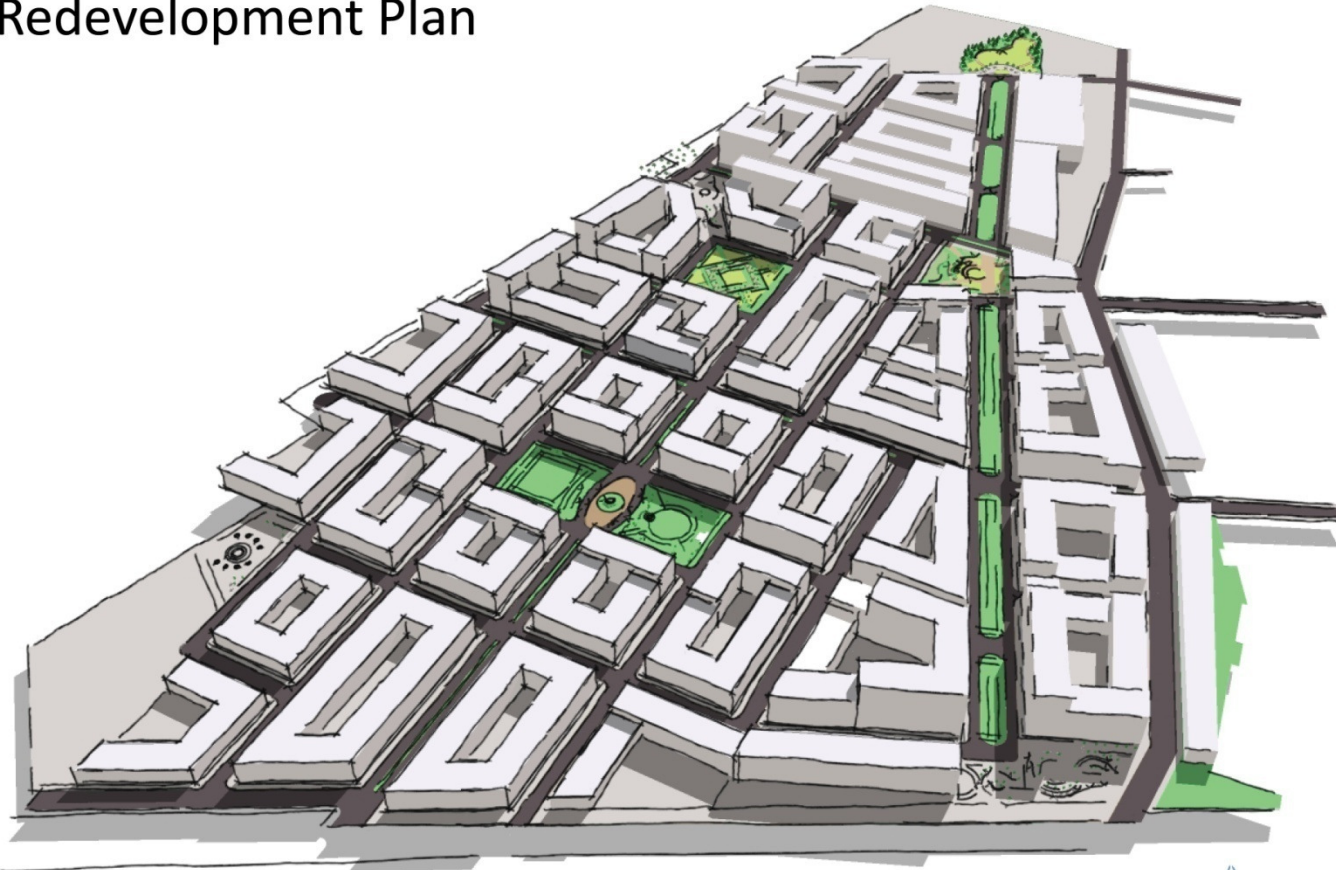

August, 2008 • CITY OF JERSEY CITY • DIVISION OF CITY PLANNING

DRESDNER ROBIN
www.dresdnerrobin.com



Chromium Cleanup
Partnership

Berry Lane Park

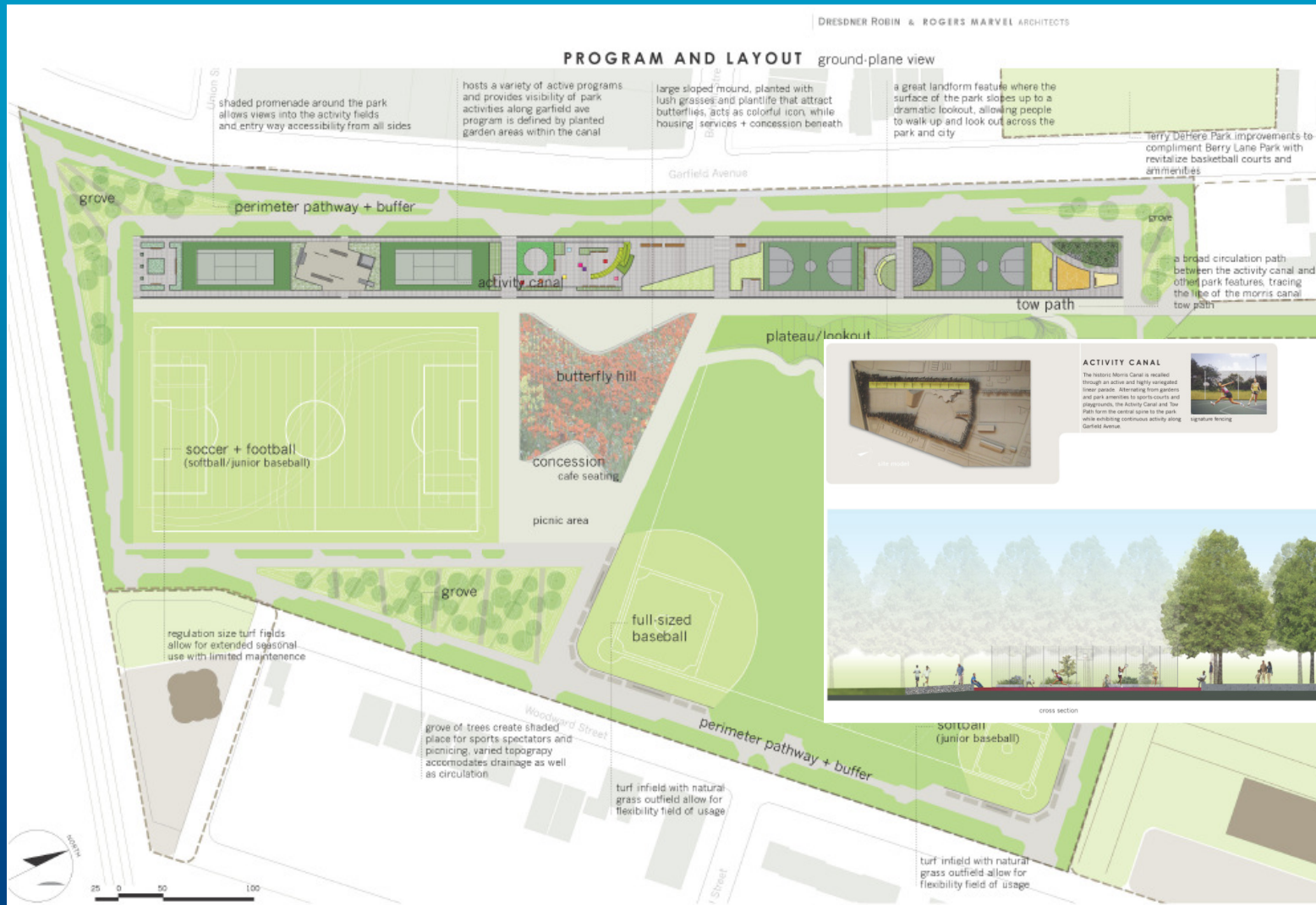

Master Schedule Overview

The Garfield Avenue and Berry Lane Sites:

- 900 Garfield Avenue has been the focus of community/residents' concern for years.
- 900 Garfield Avenue has already been extensively studied and many remediation challenges have been identified.
- To meet the five-year goal, remediation at 900 Garfield Avenue must be given priority.

Garfield Avenue Initial Remediation Program

■ Objectives

- Achieve Significant Cleanup Progress
- Generate Design Information For Final Remedy
- Enables DEP to Select Remedy Sooner

■ 2010 Activities

- Concrete Slab Removal
- Excavation & Off-site Disposal Of Green Gray Mud
- Testing Of Treatment Approach

Master Schedule Overview

At Other Sites, Contamination Mapping Needs to be Completed:

- Before starting activities, PPG is required to prepare a detailed work plan for review by the independent Technical Consultant and approval by DEP.
- At the conclusion of the investigation, contamination will be fully delineated to the satisfaction of the independent Technical Consultant and DEP.

Master Schedule Overview

Following Delineation:

- Engineering work is conducted by PPG to identify and evaluate alternatives that meet desired cleanup goals and objectives.
- This work is then reviewed by the independent Technical Consultant before DEP selects one of the alternatives.

Master Schedule Overview

Final Site Cleanup Plans:

- After the best alternative is selected by DEP, PPG will prepare a cleanup plan (known as a Remedial Action Work Plan) that details how the remediation will be implemented.
- Site cleanup plans must meet New Jersey chromium cleanup standards.
- Remedial activities will fulfill all applicable requirements of DEP's rules and regulations.

Master Schedule Overview

Final Site Cleanup Plans:

- All site cleanup plans will be reviewed by the independent Technical Consultant prior to approval by DEP.
- PPG must obtain required State and Local environmental permits and approvals.

Reports and Permits for Garfield Avenue

Reports:

- Interim Remedial Investigation Report
- Remedial Investigation Work Plan
- Final Remedial Investigation Report
- Interim Remedial Measures Work Plan #1
- Interim Remedial Action Report #1
- Interim Remedial Measures Work Plan #2
- Interim Remedial Action Report #2
- Feasibility Study Work Plan
- Feasibility Study Report
- Remedial Action Selection Report
- Remedial Action Work Plan
- Final Remedial Action Report

Permits:

- Sewer Discharge Permit
- Sewer Connection Permit
- Treatment Works Approval / NJPDES
- Soil Erosion and Sediment Control Plan
- Traffic Control Plan
- Water Allocation Permit
- Construction Permit
- Electrical Permit
- Well Permits
- Well Abandonment Permits
- Street Opening Permit
- Sidewalk Opening Permit
- DPCC Plan
- Well permits
- Fire Hydrant Opening Permit
- Digsafe Permit
- Railroad Worker

Master Schedule Overview

Final Site Cleanup Plans:

- Requests for bids for remediation services will be issued by PPG and contracts will be entered into to complete the remediation.
- Community review will occur throughout the process.

Master Schedule for PPG Chromium Sites

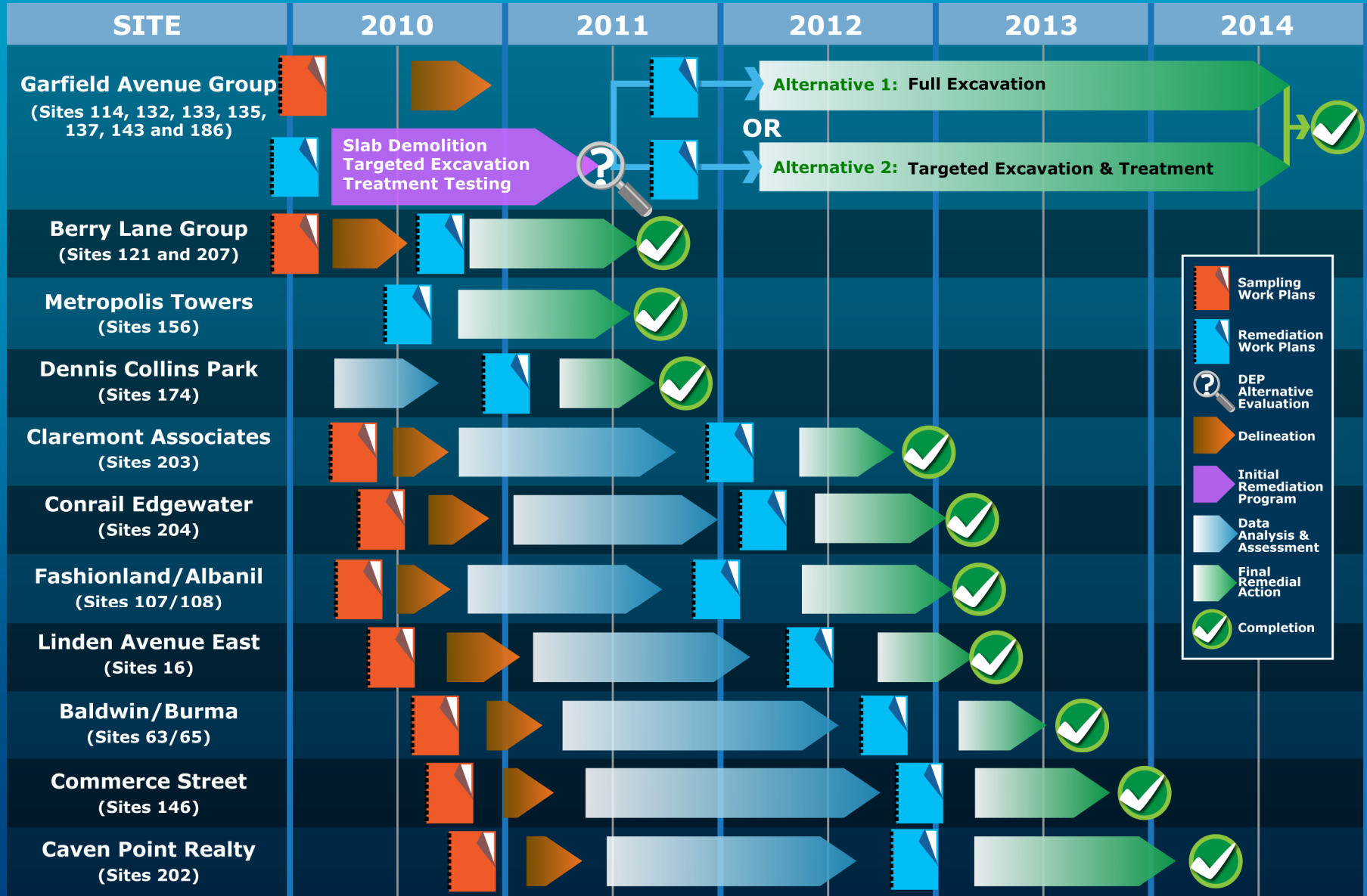

- Sampling Work Plans
- Remediation Work Plans
- DEP Alternative Evaluation
- Delineation
- Initial Remediation Program
- Data Analysis & Assessment
- Final Remedial Action
- Completion

Projected Start Date:
December 1, 2009

Chromium Cleanup
Partnership

Master Schedule Questions

Residential Sampling Overview

- Settlement provides that residents within a specific area around sites can have their property inspected and tested for the presence of chromium
- If found above health action levels, contamination will need to be cleaned up
- No cost to property owner, PPG pays
- Renters can request, but property owner will need to approve and grant access
- Projected start date of January 18, with a kick-off workshop

Residential Testing Program



Residential Testing Questions

Air Monitoring

- A combination of permanent and mobile Air Monitoring Stations will be used to continuously check to make sure that safe conditions are maintained during all cleanup activities
- These stations will monitor conditions in various zones and will protect surrounding residents by requiring that dust suppression be implemented if conditions warrant and work be halted if conditions require
- By imposing the site perimeter action levels well inside the site – at the work zone – nearby residential properties are protected

Conceptual Locations for Air Monitoring Stations

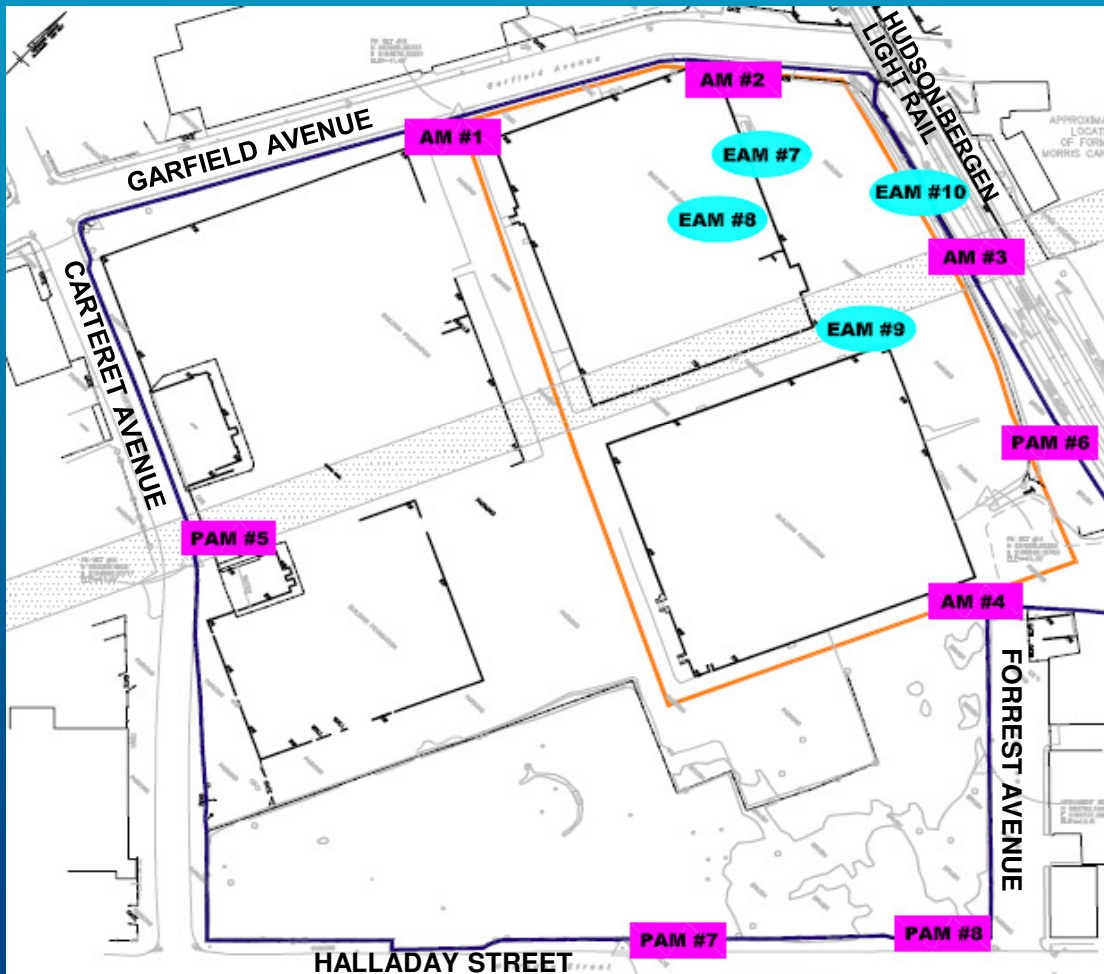

Typical Work
Zone Air
Monitoring
Stations

Typical Fence
Line Air
Monitoring
Stations

Anticipated
Initial Cleanup
Activity Area

Sample Fixed Fenceline Air Monitoring Station

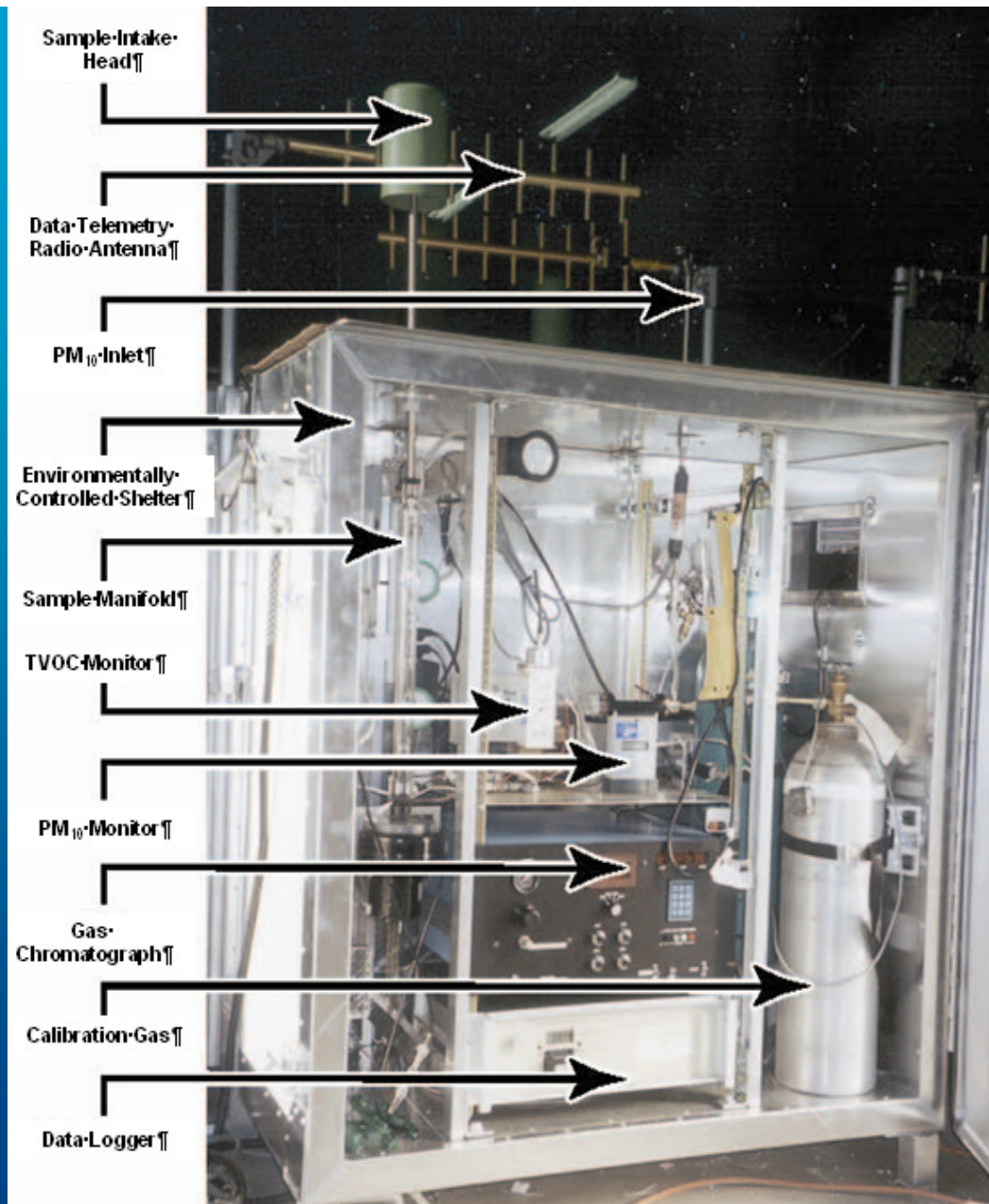

Sample Work Zone Air Monitoring Station

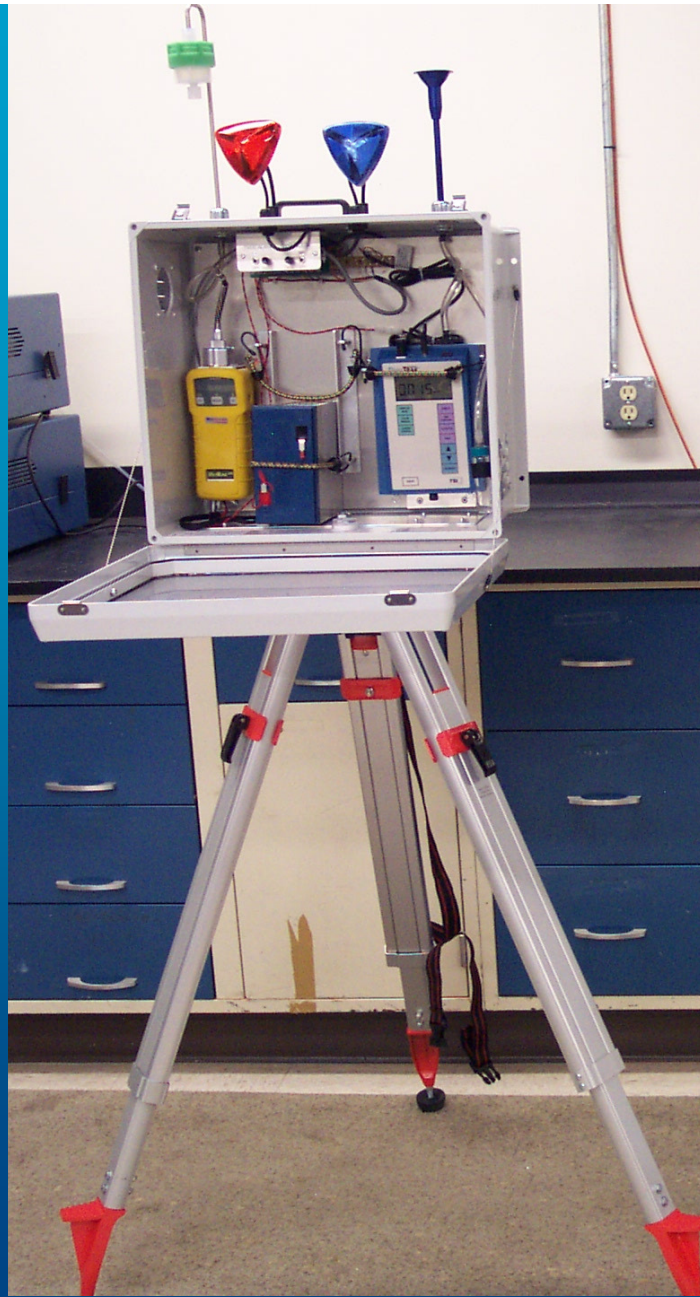

Chromium Cleanup
Partnership

Air monitoring

Truck soil and dust control:

- Loads will be sealed and secured.
- Trucks will be washed immediately after loading and again before leaving the site.

Health Study

- Settlement requires that the site administrator review chromium-related health studies, consult with experts in the field and, if necessary, recommend a health exposure study that would monitor people living within the vicinity of the Garfield Avenue site.

Health Study

- **Key questions for any community health study are:**

1. Will the data gathered detect adverse health effects directly linked to exposure to a specific contaminant (chromium waste), and are those adverse health effects amenable to prevention or intervention measures?

Health Study

2. Is the health science well enough understood to determine:
 - a. The natural history of the disease process relative to exposure?
 - b. Whether screening/intervention will have an impact on the disease process?
 - c. Whether screening tests will be accurate, reliable and determinative?
 - d. Whether the impact of screening tests will be acceptable to the patient and community?
 - e. Whether there currently is a reliable treatment or intervention procedure to prevent disease?

Health Study

■ Key dates:

- December 17, 2009 - Public Meeting to review research and solicit community input
- December 31, 2009 – Anticipated Publication of Gastrointestinal Study
 - NJ Dept. of Health and Senior Services is evaluating the relationship between historic exposure to chromium and the incidence of gastrointestinal cancers in Jersey City. Study looks at Jersey City population over a 25-year period: 1979-2003
- January 26, 2010 – Site Administrator recommendation due

Health Questions

Local Employment Program

■ Goal

- 20% of Labor Hours and Contracts.

■ PPG's Contractors

- Responsible for Hiring Workers
- Required to Satisfy Goal

■ Hiring Opportunities

- Managed through Local Trade Unions

■ Union Apprenticeship Opportunities

- Jersey City Employment and Training Program

Local Employment Program

- **OSHA Certification Training**
 - PPG Will Establish Program
- **Because Cleanups are not Labor Intensive, PPG is Working to Create Other Opportunities:**
 - Pittsburgh Paints Trade School
 - Financial Support to Rising Tide Capital
 - Support of Local Businesses

Hiring Questions

How We Reach You

- Public meetings
- Mayor's Citizen Advisory Board
- Newspaper ads
- Mail
- Web site
- Newsletters
- E-mail
- Return phone calls
- PPG's Garfield Avenue Renewal Company

How to Reach Us

- Phone: 201-777-2099
- E-mail: Info@chromecleanup.com
- Mail: Chromium Cleanup Partnership
P.O. Box 15981
Jersey City, N.J. 07305
- Visit: PPG's Garfield Avenue Renewal Company
334 Martin Luther King Drive
Tuesdays and Thursdays 10 a.m. - 2 p.m.